

25 Sprockets

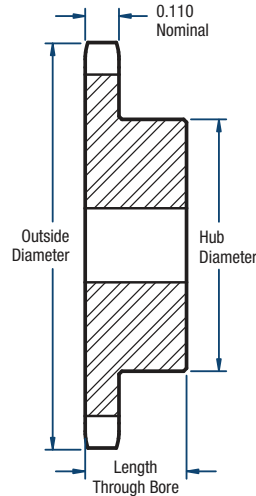

BLACKSTAR®

1/4" Pitch Stainless Steel



TYPE B

Single- Type B

No. of Teeth	Catalog Number	Diameters (in)		Bore (in)		Hub (in)		Approx. Weight (lbs)
		Outside	Pitch	Min.	Max.	Dia.	Length Through Bore	
9	25B9SS	0.84	0.731	1/4	1/4	7/16	1/2	0.03
10	25B10SS	0.92	0.809	1/4	1/4	1/2	1/2	0.03
11	25B11SS	1.00	0.887	1/4	5/16	9/16	1/2	0.03
12	25B12SS	1.08	0.966	1/4	3/8	5/8	1/2	0.06
13	25B13SS	1.17	1.045	1/4	7/16	23/32	1/2	0.07
14	25B14SS	1.25	1.124	1/4	9/16	13/16	1/2	0.08
15	25B15SS	1.33	1.203	1/4	9/16	57/64	1/2	0.10
16	25B16SS	1.41	1.282	1/4	9/16	31/32	1/2	0.12
17	25B17SS	1.49	1.361	1/4	5/8	1-1/32	1/2	0.14
18	25B18SS	1.57	1.440	1/4	3/4	1-1/8	1/2	0.16
19	25B19SS	1.65	1.519	1/4	13/16	1-7/32	1/2	0.19
20	25B20SS	1.73	1.598	1/4	7/8	1-9/32	5/8	0.25
21	25B21SS	1.81	1.678	1/4	7/8	1-3/8	5/8	0.28
22	25B22SS	1.89	1.757	1/4	15/16	1-7/16	5/8	0.31
23	25B23SS	1.97	1.836	1/4	1	1-1/2	5/8	0.32
24	25B24SS	2.05	1.915	3/8	1	1-1/2	5/8	0.33
25	25B25SS	2.13	1.995	3/8	1	1-1/2	5/8	0.34
26	25B26SS	2.21	2.074	3/8	1	1-1/2	5/8	0.35
28	25B28SS	2.37	2.233	3/8	1	1-1/2	5/8	0.36
30	25B30SS	2.53	2.392	3/8	1	1-1/2	5/8	0.38
32	25B32SS	2.69	2.551	3/8	1	1-1/2	5/8	0.40
35	25B35SS	2.93	2.789	3/8	1	1-1/2	3/4	0.48
36	25B36SS	3.01	2.869	3/8	1	1-1/2	3/4	0.50
40	25B40SS	3.33	3.187	1/2	1-3/8	2	3/4	0.53
45	25B45SS	3.73	3.584	1/2	1-3/8	2	3/4	0.56
60	25B60SS	4.92	4.777	1/2	1-3/8	2	3/4	1.10

NOTE: Maximum bores shown will accommodate a standard keyseat and a setscrew over the keyseat. Slightly larger bores are possible with no keyseat, a shallow keyseat, or a setscrew at an angle to the keyseat.