

# 35 Sprockets



# BLACKSTAR®

## 3/8" Pitch

## Stainless Steel

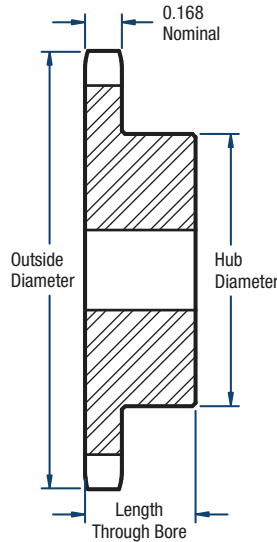

**TYPE B**

### Single- Type B

No. of Teeth	Catalog Number	Diameters (in)		Bore (in)		Hub (in)		Approx. Weight (lbs)
		Outside	Pitch	Min.	Max.	Dia.	Length Through Bore	
9	35B9SS	1.26	1.097	3/8	3/8	27/32*	3/4	0.10
10	35B10SS	1.38	1.214	3/8	9/16	31/32*	3/4	0.15
11	35B11SS	1.50	1.331	3/8	9/16	1-1/16*	3/4	0.20
12	35B12SS	1.63	1.449	1/2	5/8	1-7/32*	3/4	0.22
13	35B13SS	1.75	1.567	1/2	3/4	1-1/4*	3/4	0.25
14	35B14SS	1.87	1.685	1/2	7/8	1-1/4	3/4	0.26
15	35B15SS	1.99	1.804	1/2	7/8	1-11/32	3/4	0.30
16	35B16SS	2.11	1.922	1/2	15/16	1-15/32	3/4	0.40
17	35B17SS	2.23	2.041	1/2	1-1/16	1-19/32	3/4	0.43
18	35B18SS	2.35	2.160	1/2	1-3/16	1-23/32	3/4	0.50
19	35B19SS	2.47	2.279	1/2	1-1/4	1-27/32	3/4	0.56
20	35B20SS	2.59	2.397	1/2	1-5/16	1-15/16	3/4	0.68
21	35B21SS	2.71	2.516	1/2	1-3/8	2	7/8	0.80
22	35B22SS	2.83	2.635	1/2	1-3/8	2	7/8	0.82
23	35B23SS	2.95	2.754	1/2	1-3/8	2	7/8	0.87
24	35B24SS	3.07	2.873	1/2	1-3/8	2	7/8	0.89
25	35B25SS	3.19	2.992	1/2	1-3/8	2	7/8	0.91
26	35B26SS	3.31	3.111	1/2	1-3/8	2	7/8	0.93
28	35B28SS	3.55	3.349	1/2	1-3/8	2	7/8	1.00
30	35B30SS	3.79	3.588	1/2	1-3/8	2	7/8	1.06
32	35B32SS	4.03	3.826	1/2	1-3/8	2	7/8	1.24
35	35B35SS	4.39	4.184	5/8	1-1/2	2-1/4	7/8	1.56
36	35B36SS	4.51	4.303	5/8	1-1/2	2-1/4	7/8	1.60
40	35B40SS	4.99	4.780	5/8	1-1/2	2-1/4	1	1.70
45	35B45SS	5.59	5.376	5/8	1-1/2	2-1/4	1	2.18
60	35B60SS	7.38	7.165	3/4	1-1/2	2-1/4	1	3.00

\*Has a recessed groove in the hub for chain clearance.

**NOTE:** Maximum bores shown will accommodate a standard keyseat and a setscrew over the keyseat. Slightly larger bores are possible with no keyseat, a shallow keyseat, or a setscrew at an angle to the keyseat.