

60 Sprockets

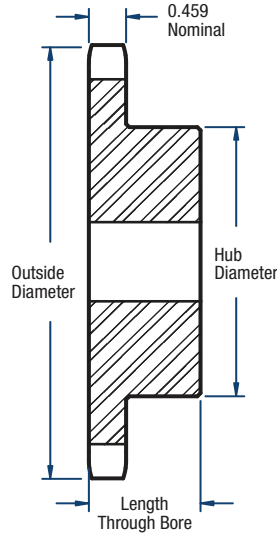

BLACKSTAR®

3/4" Pitch Stainless Steel



TYPE B

Single- Type B

No. of Teeth	Catalog Number	Diameters (in)		Bore (in)		Hub (in)		Approx. Weight (lbs)
		Outside	Pitch	Min.	Max.	Diameter	Length Through Bore	
8	60B8SS	2.26	1.960	5/8	5/8	1-15/32*	1-1/4	0.54
9	60B9SS	2.51	2.193	3/4	7/8	1-9/16*	1-1/4	0.64
10	60B10SS	2.76	2.427	3/4	1-1/8	1-15/16*	1-1/4	0.99
11	60B11SS	3.01	2.663	3/4	1-5/16	2-1/16*	1-1/4	1.16
12	60B12SS	3.25	2.898	3/4	1-3/8	2-3/8*	1-1/4	1.50
13	60B13SS	3.49	3.134	3/4	1-1/2	2-11/32	1-1/4	1.71
14	60B14SS	3.74	3.371	3/4	1-3/4	2-9/16	1-1/4	2.05
15	60B15SS	3.98	3.608	3/4	1-7/8	2-7/8	1-1/4	2.51
16	60B16SS	4.22	3.845	3/4	2	3-1/16	1-1/4	2.88
17	60B17SS	4.46	4.082	3/4	2-1/4	3-1/4	1-1/4	3.27
18	60B18SS	4.70	4.319	3/4	2-3/8	3-1/2	1-1/4	3.77
19	60B19SS	4.95	4.557	3/4	2-3/8	3-1/2	1-1/4	3.98
20	60B20SS	5.19	4.794	3/4	2-5/8	3-7/8	1-1/4	4.69
21	60B21SS	5.43	5.033	3/4	2-3/4	4	1-1/4	5.10
22	60B22SS	5.67	5.270	3/4	2-3/4	4	1-1/4	5.34
23	60B23SS	5.91	5.508	3/4	2-3/4	4	1-1/4	5.59
24	60B24SS	6.15	5.746	3/4	2-3/4	4	1-1/4	5.59
25	60B25SS	6.39	5.984	3/4	2-3/4	4	1-1/4	6.13
26	60B26SS	6.63	6.222	3/4	2-3/4	4	1-1/4	6.42
28	60B28SS	7.11	6.698	3/4	2-3/4	4	1-1/4	7.03
30	60B30SS	7.59	7.175	3/4	2-3/4	4	1-1/4	7.69
32	60B32SS	8.07	7.652	3/4	2-3/4	4	1-1/4	5.26
35	60B35SS	8.78	8.367	1	2-3/4	4	1-1/4	9.41
36	60B36SS	9.02	8.606	1	2-3/4	4	1-1/4	9.60
40	60B40SS	9.98	9.560	1	2-3/4	4-1/4	1-1/4	11.91
45	60B45SS	11.18	10.752	1	2-3/4	4-1/4	1-1/4	14.34
60	60B60SS	14.76	14.330	1-1/4	2-3/4	4-1/4	1-3/4	25.05

*Has recessed groove in the hub for chain clearance.

NOTE: Maximum bores shown will accommodate a standard keyseat and a setscrew over the keyseat. Slightly larger bores are possible with no keyseat, a shallow keyseat, or a setscrew at an angle to the keyseat.