

80 Sprockets

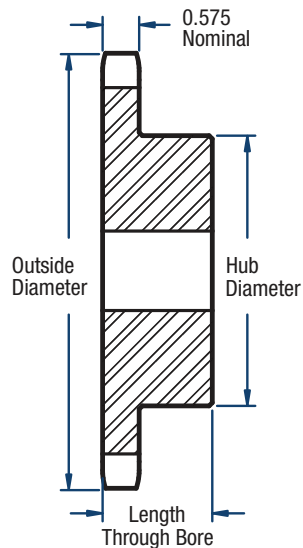

BLACKSTAR®

1" Pitch Stainless Steel



TYPE B

Single- Type B

No. of Teeth	Catalog Number	Diameters (in)		Bore (in)		Hub (in)		Approx. Weight (lbs)
		Outside	Pitch	Minimum	Maximum	Diameter	Length Through Bore	
10	80B10SS	3.68	3.236	1	1 1/2	2 9/16*	1 5/8	2.14
11	80B11SS	4.01	3.550	1	1 5/8	2 13/16*	1 5/8	2.72
12	80B12SS	4.33	3.864	1	1 7/8	3 1/8*	1 5/8	3.42
13	80B13SS	4.66	4.179	1	2	3	1 1/2	3.53
14	80B14SS	4.98	4.494	1	2 1/4	3 1/4	1 1/2	4.19
15	80B15SS	5.30	4.810	1	2 1/2	3 13/16	1 1/2	5.38
16	80B16SS	5.63	5.126	1	2 3/4	4	1 1/2	6.07
17	80B17SS	5.95	5.442	1	2 3/4	4	1 1/2	6.45
18	80B18SS	6.27	5.759	1	2 3/4	4 1/4	1 1/2	7.34
19	80B19SS	6.59	6.076	1	2 3/4	4 1/4	1 1/2	7.80
20	80B20SS	6.91	6.392	1	2 3/4	4 1/4	1 1/2	8.22
21	80B21SS	7.24	6.710	1	2 3/4	4 1/4	1 3/4	9.40
22	80B22SS	7.56	7.027	1	2 3/4	4 1/4	1 3/4	10.00
23	80B23SS	7.88	7.344	1	2 3/4	4 1/4	1 3/4	10.70
24	80B24SS	8.20	7.661	1	2 3/4	4 1/4	1 3/4	11.36
25	80B25SS	8.52	7.979	1	2 3/4	4 1/4	1 3/4	11.90
26	80B26SS	8.84	8.296	1 1/4	3 1/4	4 3/4	2	14.57
30	80B30SS	10.11	9.567	1 3/16	3 1/4	4 3/4	2	17.50
35	80B35SS	11.71	11.156	1 3/16	3 1/4	4 3/4	2	21.48
40	80B40SS	13.31	12.746	1 3/16	3 1/4	4 3/4	2	26.00

*Has recessed groove in the hub for chain clearance.

NOTE: Maximum bores shown will accommodate a standard keyseat and a setscrew over the keyseat. Slightly larger bores are possible with no keyseat, a shallow keyseat, or a setscrew at an angle to the keyseat.