

T100 Sprockets

1 1/4" Pitch

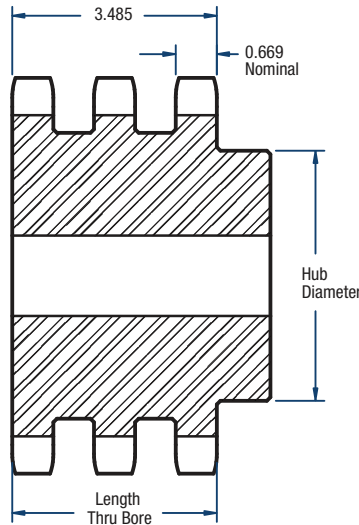

BLACKSTAR®



TYPE B

Triple- Type B

No. of Teeth	Catalog Number	Diameters (in)		Type	Bore (in)		Hub (in)		Approx. Weight (lbs)
		Outside	Pitch		Minimum	Maximum	Diameter	Length Through Bore	
11	T100B11H	5.01	4.438	B	1	2-1/8	3-1/8	4-1/4	11.7
12	T100B12H	5.42	4.830	B	1-1/8	2-1/4	3-3/8	4-1/4	13.7
13	T100B13H	5.82	5.224	B	1-1/8	2-1/2	3-13/16	4-1/4	16.9
14	T100B14H	6.23	5.618	B	1-1/8	2-3/4	4-3/16	4-1/4	20.2
15	T100B15H	6.63	6.013	B	1-1/4	3-1/8	4-5/8	4-1/2	25.0
16	T100B16H	7.03	6.408	B	1-1/4	3-5/16	5	4-1/2	29.3
17	T100B17H	7.44	6.803	B	1-1/4	3-1/2	5-1/4	4-1/2	33.8
18	T100B18H	7.84	7.199	B	1-1/4	3-1/2	5-1/4	4-3/4	38.6
19	T100B19H	8.24	7.595	B	1-1/4	3-3/4	5-1/2	4-3/4	43.3
20	T100B20H	8.64	7.990	B	1-1/4	3-3/4	5-1/2	4-3/4	47.9
21	T100B21H	9.04	8.388	B	1-1/4	3-3/4	5-1/2	4-3/4	52.3
22	T100B22H	9.44	8.784	B	1-1/4	3-3/4	5-1/2	4-3/4	57.5
23	T100B23H	9.85	9.180	B	1-1/4	3-3/4	5-1/2	4-3/4	62.5
24	T100B24H	10.25	9.576	B	1-1/4	3-3/4	5-3/4	4-3/4	69.0
25	T100B25H	10.65	9.974	B	1-1/4	3-3/4	5-3/4	4-3/4	73.0
26	T100B26H	11.05	10.370	B	1-1/2	3-13/16	5-3/4	4-3/4	79.0
30	T100B30H	12.64	11.959	B	1-1/2	3-13/16	5-3/4	4-3/4	103.0

Sprockets with "H" suffix have hardened teeth.

NOTE: Maximum bores shown will accommodate a standard keyseat and a setscrew over the keyseat. Slightly larger bores are possible with no keyseat, a shallow keyseat, or a setscrew at an angle to the keyseat.