

T80 Sprockets

1" Pitch

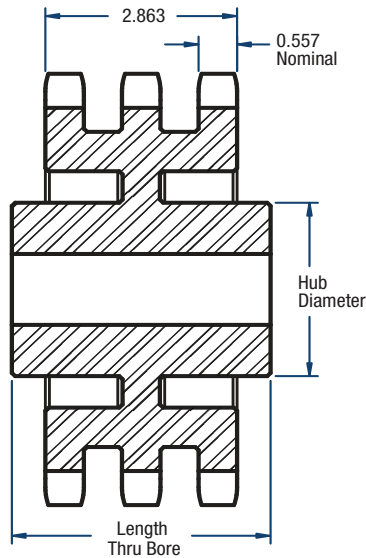

BLACKSTAR®



TYPE C

Triple- Type C

No. of Teeth	Catalog Number	Diameters (in)		Type	Bore (in)		Hub (in)		Approx. Weight (lbs)
		Outside	Pitch		Minimum	Maximum	Diameter	Length Through Bore	
42	T80C42	13.94	13.382	C	1-1/4	3-13/16	6	4-1/2	84.9
45	T80C45	14.90	14.336	C	1-1/4	3-13/16	6	4-1/2	92.4
52	T80C52	17.13	16.562	C	1-1/2	3-13/16	6	4-1/2	107.0
60	T80C60	19.68	19.107	C	1-1/2	4-1/4	6-1/4	4-3/4	128.0
68	T80C68	22.23	21.653	C	1-1/2	4-1/4	6-1/4	4-3/4	140.0
76	T80C76	24.78	24.198	C	1-1/2	4-1/4	6-1/4	4-3/4	165.0
95	T80C95	30.83	30.245	C	1-1/2	4-1/2	6-3/4	5	240.0

NOTE: Maximum bores shown will accommodate a standard keyseat and a setscrew over the keyseat. Slightly larger bores are possible with no keyseat, a shallow keyseat, or a setscrew at an angle to the keyseat.