

CUSTOMER DWG

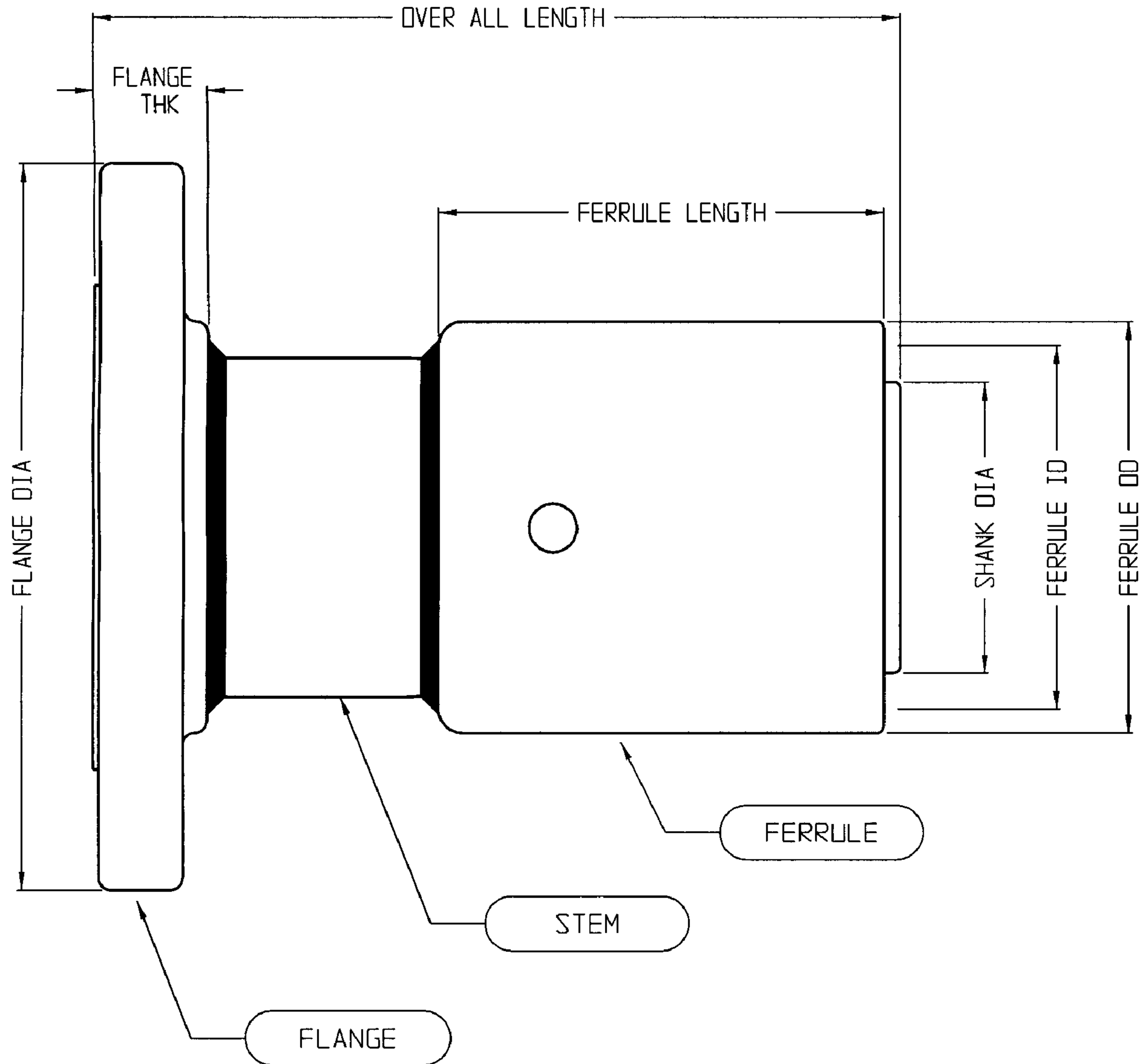

128P3S015	14.1/2	1.3/4	13.1/2	8.1/8	10.3/8	9.7/8	8.3/32
128P2S015	14.1/2	1.3/4	13.1/2	8.1/8	10.1/4	9.3/4	8.3/32
128P1S015	14.1/2	1.3/4	13.1/2	8.1/8	10.1/8	9.5/8	8.3/32
96P3S015	13.5/32	1.9/16	11	6.3/4	8	7.1/2	6.3/32
96P2S015	13.5/32	1.9/16	11	6.11/16	7.3/4	7.3/8	6.3/32
96P1S015	13.5/32	1.9/16	11	6.11/16	7.5/8	7.1/4	6.3/32
64P3S015	9.1/2	1.5/16	9	5.5/16	5.1/2	5.3/16	4.1/16
64P2S015	9.1/2	1.5/16	9	5.1/4	5.1/4	5	4.1/16
64P1S015	9.1/2	1.5/16	9	5.5/16	5.1/4	4.15/16	4.1/16
48P3S015	8.3/8	1.3/16	7.1/2	4.5/8	4.1/4	4	3.1/16
48P2S015	8.3/8	1.3/16	7.1/2	4.5/8	4.1/8	3.7/8	3.1/16
48P1S015	8.3/8	1.3/16	7.1/2	4.5/8	4	3.3/4	3.1/16
32P3S015	6.5/8	1	6	3.1/2	3.1/4	3	2.1/16
32P2S015	6.5/8	1	6	3.1/2	3.1/8	2.7/8	2.1/16
32P1S015	6.5/8	1	6	3.1/2	3	2.3/4	2.1/16

PART #	OVER ALL LENGTH	FLANGE THK	FLANGE DIA	FERRULE LENGTH	FERRULE OD	FERRULE ID	SHANK DIA
--------	-----------------	------------	------------	----------------	------------	------------	-----------

DIXON VALVE & COUPLING CO.
U. S. A.

TITLE
HOLEBALL ASSEMBLY w/ SLIP-ON FLANGE

DRAWN BY: MHM
2/13/04

CHECKED BY:

APPROVAL: *JOB*
2/18/04

MAT'L
CARBON STEEL

XXPXS015

AGREEMENT TO MAINTAIN CONFIDENTIALITY

This drawing is owned by Dixon Valve & Coupling Co. and shall be returned upon demand. It is loaned on condition that it shall not be copied or reproduced or submitted to others without the owners consent. In accepting it subject to this condition the recipient further agrees that this drawing or any design detail or concept disclosed herein shall not be used in any way detrimental to or in competition with the Owner. If the recipient does not agree to the terms of this agreement, they shall return this drawing immediately.

