

**BALDOR® • RELIANCE** 

**Product Information Packet**

**AOM3535**

**.33HP, 1140RPM, 3PH, 60HZ, 56, 3414M, TEAO, F1**

| Part Detail |        |             |            |             |        |               |            |
|-------------|--------|-------------|------------|-------------|--------|---------------|------------|
| Revision:   | B      | Status:     | PRD/A      | Change #:   |        | Proprietary:  | No         |
| Type:       | AC     | Elec. Spec: | 34WG5883   | CD Diagram: | CD0005 | Mfg Plant:    |            |
| Mech. Spec: | 34T045 | Layout:     | 34LYT045   | Poles:      | 06     | Created Date: | 11-20-2007 |
| Base:       | RG     | Eff. Date:  | 08-20-2018 | Leads:      | 9#18   |               |            |

| Specs                           |                         |                                |                   |
|---------------------------------|-------------------------|--------------------------------|-------------------|
| Catalog Number:                 | AOM3535                 | Heater Indicator:              | No Heater         |
| Enclosure:                      | TEAO                    | Insulation Class:              | F                 |
| Frame:                          | 56                      | Inverter Code:                 | Not Inverter      |
| Frame Material:                 | Steel                   | KVA Code:                      | K                 |
| Output @ Frequency:             | .330 HP @ 60 HZ         | Lifting Lugs:                  | No Lifting Lugs   |
| Synchronous Speed @ Frequency:  | 1200 RPM @ 60 HZ        | Locked Bearing Indicator:      | No Locked Bearing |
| Voltage @ Frequency:            | 208.0 V @ 60 HZ         | Motor Lead Quantity/Wire Size: | 9 @ 18 AWG        |
|                                 | 460.0 V @ 60 HZ         | Motor Lead Exit:               | Ko Box            |
|                                 | 230.0 V @ 60 HZ         | Motor Lead Termination:        | Flying Leads      |
| XP Class and Group:             | None                    | Motor Type:                    | 3414M             |
| XP Division:                    | Not Applicable          | Mounting Arrangement:          | F1                |
| Agency Approvals:               | CSA                     | Power Factor:                  | 51                |
|                                 | UR                      | Product Family:                | General Purpose   |
| Auxillary Box:                  | No Auxillary Box        | Pulley End Bearing Type:       | Ball              |
| Auxillary Box Lead Termination: | None                    | Pulley Face Code:              | Standard          |
| Base Indicator:                 | Rigid                   | Pulley Shaft Indicator:        | Standard          |
| Bearing Grease Type:            | Polyrex EM (-20F +300F) | Rodent Screen:                 | None              |
| Blower:                         | None                    | Shaft Extension Location:      | Pulley End        |

|                                       |                           |                                    |                     |
|---------------------------------------|---------------------------|------------------------------------|---------------------|
| <b>Current @ Voltage:</b>             | 2.100 A @ 208.0 V         | <b>Shaft Ground Indicator:</b>     | No Shaft Grounding  |
|                                       | 1.900 A @ 208.0 V         | <b>Shaft Rotation:</b>             | Reversible          |
|                                       | 1.800 A @ 230.0 V         | <b>Shaft Slinger Indicator:</b>    | No Slinger          |
|                                       | .900 A @ 460.0 V          | <b>Speed Code:</b>                 | Single Speed        |
| <b>Design Code:</b>                   | B                         | <b>Motor Standards:</b>            | NEMA                |
| <b>Drip Cover:</b>                    | No Drip Cover             | <b>Starting Method:</b>            | Direct on line      |
| <b>Duty Rating:</b>                   | CONT                      | <b>Thermal Device - Bearing:</b>   | NONE (OLD)          |
| <b>Electrically Isolated Bearing:</b> | Not Electrically Isolated | <b>Thermal Device - Winding:</b>   | None                |
| <b>Feedback Device:</b>               | NO FEEDBACK               | <b>Vibration Sensor Indicator:</b> | No Vibration Sensor |
| <b>Front Face Code:</b>               | Standard                  | <b>Winding Thermal 1:</b>          | None                |
| <b>Front Shaft Indicator:</b>         | None                      | <b>Winding Thermal 2:</b>          | None                |

| Nameplate NP1256L |               |  |  |  |  |      |      |  |     |                |       |   |
|-------------------|---------------|--|--|--|--|------|------|--|-----|----------------|-------|---|
| CAT.NO.           | AOM3535       |  |  |  |  |      |      |  |     |                |       |   |
| SPEC.             | 34T045-5883G2 |  |  |  |  |      |      |  |     |                |       |   |
| HP                | .33           |  |  |  |  |      |      |  |     |                |       |   |
| VOLTS             | 208-230/460   |  |  |  |  |      |      |  |     |                |       |   |
| AMP               | 1.9-1.8/.9    |  |  |  |  |      |      |  |     |                |       |   |
| RPM               | 1140          |  |  |  |  |      |      |  |     |                |       |   |
| FRAME             | 56            |  |  |  |  | HZ   | 60   |  |     | PH             | 3     |   |
| SER.F.            | 1.00          |  |  |  |  | CODE | K    |  | DES | B              | CLASS | F |
| NEMA-NOM-EFF      | 70            |  |  |  |  | PF   | 51   |  |     |                |       |   |
| RATING            | 40C AMB-CONT  |  |  |  |  |      |      |  |     |                |       |   |
| CC                |               |  |  |  |  |      |      |  |     | USABLE AT 208V | 2.1   |   |
| DE                | 6203          |  |  |  |  | ODE  | 6203 |  |     |                |       |   |
| ENCL              | TEAO          |  |  |  |  | SN   |      |  |     |                |       |   |
|                   |               |  |  |  |  |      |      |  |     |                |       |   |

| Parts List    |  |          |
|---------------|--|----------|
| Part Number   | Description                              | Quantity |
| SA165149      | SA 34T045-5883G2                         | 1.000 EA |
| RA153561      | RA 34T045-5883G2                         | 1.000 EA |
| NS2512A01     | INSULATOR, CONDUIT BOX X                 | 1.000 EA |
| 34CB3002A     | CB CAST W/.88 DIA HOLE                   | 1.000 EA |
| 34GS1029A01   | GASKET, CONDUIT BOX                      | 1.000 EA |
| 51XB1016A07   | 10-16 X 7/16 HXWSSLD SERTYB              | 2.000 EA |
| 11XW1032G06   | 10-32 X .38, TAPTITE II, HEX WSHR SLTD U | 1.000 EA |
| 34EP3100A03SP | FR ENDPLATE, MACH                        | 1.000 EA |
| HW5100A03     | WAVY WASHER (W1543-017)                  | 1.000 EA |
| 34EP3102A02SP | FR/PU ENDPLATE, MACH                     | 1.000 EA |
| XY1032A02     | 10-32 HEX NUT DIRECTIONAL SERRATION      | 4.000 EA |
| 34CB4517      | CB LID 4 MTG HOLES .22 DIA STAMPED, FOR  | 1.000 EA |
| 34GS1031A01   | GASKET, FLAT CONDUIT BOX LID (LEXIDE)    | 1.000 EA |
| 51XW0832A07   | 8-32 X .44, TAPTITE II, HEX WSHR SLTD SE | 4.000 EA |
| HW2501D13     | KEY, 3/16 SQ X 1.375                     | 1.000 EA |
| HA7000A04     | KEY RETAINER 0.625 DIA SHAFTS            | 1.000 EA |
| MG1000G27     | MED CHARCOAL METALLIC GREY 400-0096      | 0.014 GA |
| 85XU0407S04   | 4X1/4 U DRIVE PIN STAINLESS              | 2.000 EA |
| HA3100A12     | THRUBOLT 10-32 X 7.375                   | 4.000 EA |
| MN416A01      | TAG-INSTAL-MAINT no wire (1200/bx) 5/18  | 1.000 EA |
| LC0005E01     | CONN.DIA./WARNING LABEL (LC0005/LB1119N) | 1.000 EA |
| NP1256L       | ALUM UL CSA CC INDUSTRIAL MOTOR A60      | 1.000 EA |
| 34PA1002      | PKG GRP, PRINT PK1001A01                 | 1.000 EA |

**AC Induction Motor Performance Data**

Record # 36354 - Typical performance - not guaranteed values

|                               |                    |                        |
|-------------------------------|--------------------|------------------------|
| <b>Winding:</b> 34WG5883-R015 | <b>Type:</b> 3414M | <b>Enclosure:</b> TEAO |
|-------------------------------|--------------------|------------------------|

| Nameplate Data        |              |              |    | 460 V, 60 Hz:<br>High Voltage Connection |                           |
|-----------------------|--------------|--------------|----|--|---------------------------|
| Rated Output (HP)     | .33          |              |    | Full Load Torque                         | 1.5 LB-FT                 |
| Volts                 | 208-230/460  |              |    | Start Configuration                      | direct on line            |
| Full Load Amps        | 1.9-1.8/.9   |              |    | Breakdown Torque                         | 5.5 LB-FT                 |
| R.P.M.                | 1140         |              |    | Pull-up Torque                           | 4.2 LB-FT                 |
| Hz                    | 60           | Phase        | 3  | Locked-rotor Torque                      | 4.45 LB-FT                |
| NEMA Design Code      | B            | KVA Code     | K  | Starting Current                         | 3.65 A                    |
| Service Factor (S.F.) | 1            |              |    | No-load Current                          | 0.75 A                    |
| NEMA Nom. Eff.        | 70           | Power Factor | 51 | Line-line Res. @ 25°C                    | 58.3 Ω                    |
| Rating - Duty         | 40C AMB-CONT |              |    | Temp. Rise @ Rated Load                  |                           |
|                       |              |              |    | Locked-rotor Power Factor                | 66                        |
|                       |              |              |    | Rotor inertia                            | 0.0333 LB-FT <sup>2</sup> |

Load Characteristics 460 V, 60 Hz, 0.33 HP

| % of Rated Load | 25   | 50   | 75   | 100  | 125  | 150  |
|-----------------|------|------|------|------|------|------|
| Power Factor    | 19   | 30   | 42   | 51   | 58   | 64   |
| Efficiency      | 44   | 58   | 66   | 70   | 71   | 72   |
| Speed           | 1185 | 1170 | 1155 | 1135 | 1120 | 1095 |
| Line amperes    | 0.75 | 0.8  | 0.85 | 0.9  | 0.95 | 1.05 |

Performance Graph at 460V, 60Hz, 0.33HP Typical performance - Not guaranteed values

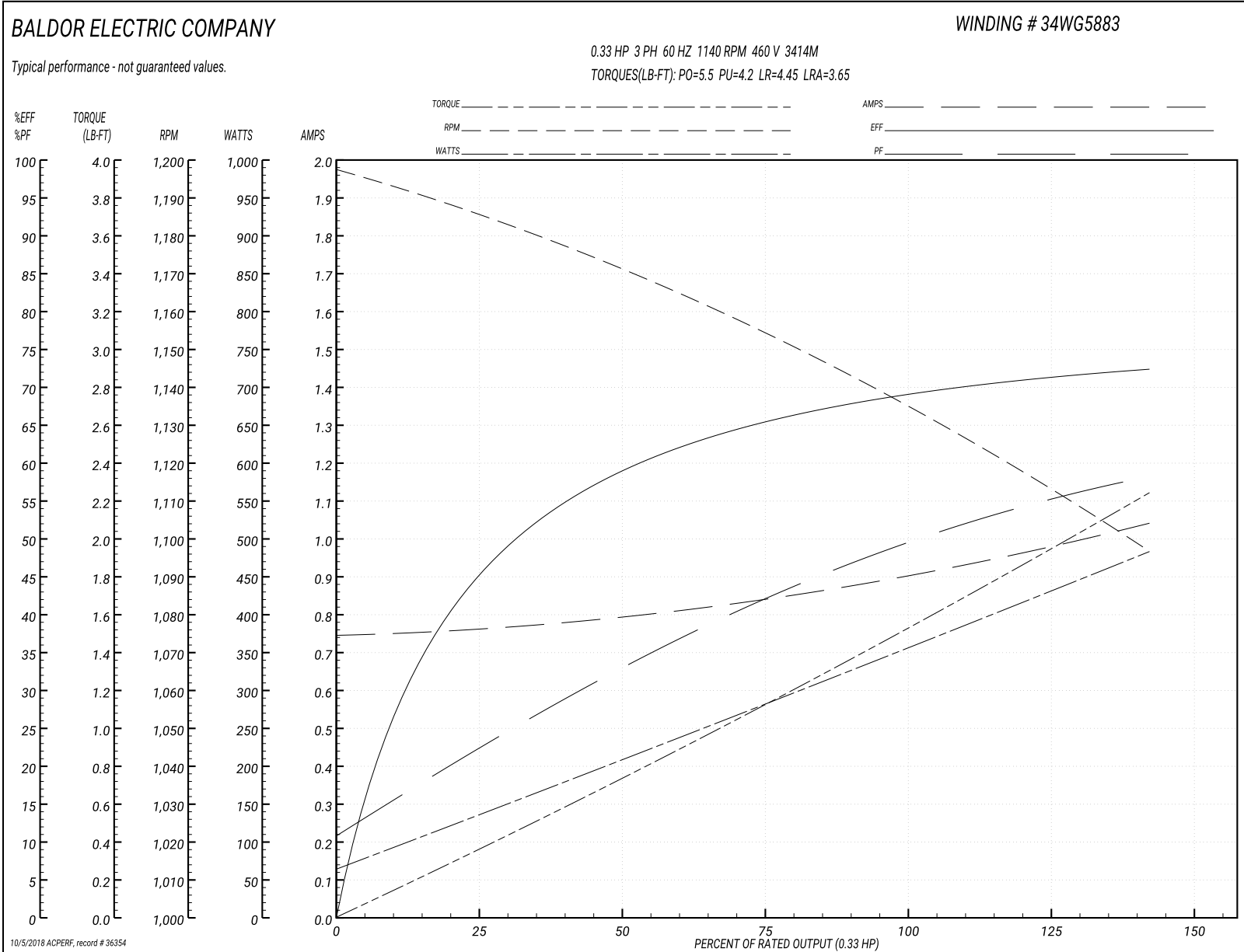

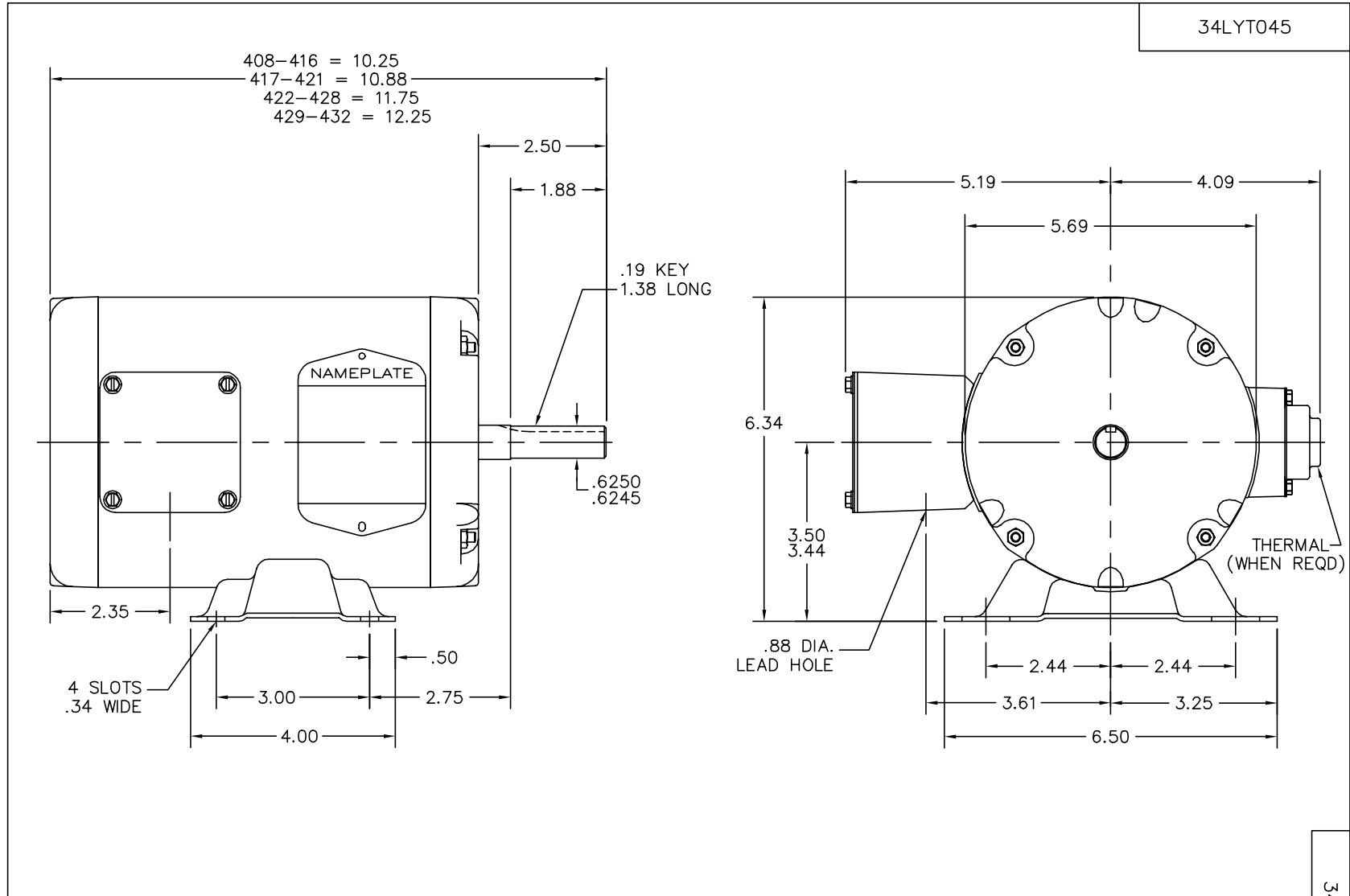

CUSTOMER IS RESPONSIBLE FOR DETERMINING THAT MOTOR PERFORMANCE IS SUITABLE IN THE APPLICATION.

|                            |                      |                              |
|----------------------------|----------------------|------------------------------|
| REV. DESC: UPDATED DRAWING |                      |                              |
| REV. LTR: D                | VERSION: 01          | TDR: 000000424850            |
| 34LYT045                   | FILE: \AAA\00026\166 | REVISED: 08:19:50 03/13/2007 |
|                            | MTL: -               | BY: ENRSTO                   |

**BALDOR ELECTRIC Co.**

STD HORZ MODEL 34M NEMA 56 TEAO

34LYT045



CD0005



LOW VOLTAGE  
(2Y)

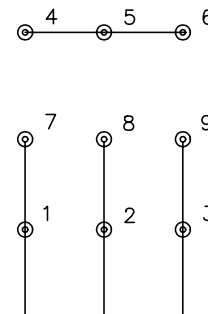

LINE

HIGH VOLTAGE  
(1Y)

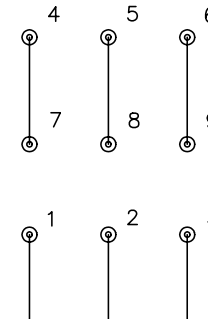

LINE

NOTES:

1. INTERCHANGE ANY TWO LINE LEADS TO REVERSE ROTATION.
2. OPTIONAL THERMOSTATS ARE PROVIDED WHEN SPECIFIED.
3. ACTUAL NUMBER OF INTERNAL PARALLEL CIRCUITS MAY BE A MULTIPLE OF THOSE SHOWN ABOVE.
4. LEAD COLORS ARE OPTIONAL. LEADS MUST ALWAYS BE NUMBERED AS SHOWN.

|   |         |                         |              |
|---|---------|-------------------------|--------------|
| REV. DESC: REVISE TO SHOW OPTIONAL COLORS |         |                         |              |
| REV. LTR: E                               | BY: JLP | REVISED: 01/19/99 10:15 | TDR: 0171435 |
| 90000                                     |         | FILE: AAA00005140       | MDL: -       |
|   |         | MTL: -                  |              |

**BALDOR ELECTRIC Co.**

3PH, DV, 9 LEADS

CD0005