

Y Ball Check Valves

When liquid flows through the valve, the ball is forced into the branch of the valve allowing full fluid flow. When the liquid stops, equalizing the pressure, the ball drops back into the seat, preventing backflow. Should reverse flow occur, the differential pressure will cause the ball to seal firmly against the seat preventing leakage.

Features:

- maximum operating pressure: **150 PSI**
- temperature range: **15° to 200°F**
- two piece construction for easier alignment during installation
- ID and OD polished to 3A standards
- all metal contact surfaces of 316L stainless steel construction
- PTFE ball
- replaceable seat
- field serviceable without special tools
- various end configurations available: clamp, weld, I-line, Q-line, bevel seat and John Perry
- air blow check valve can be added (see air blow for sizing)

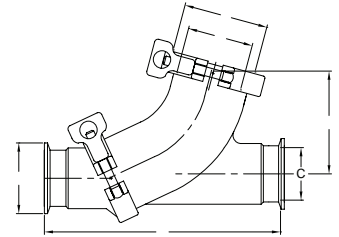

Size	Dimensions						316L Stainless Steel	
	A	B	C	D	E	F	Part #	Price/E
1½"	7.50"	3.30"	1.36"	1.87"	1.98"	2.51"	B45BY-R150	\$788.15
2"	8.50"	3.90"	1.86"	2.33"	2.51"	3.04"	B45BY-R200	983.95
2½"	10.00"	4.50"	2.37"	2.87"	3.04"	3.57"	B45BY-R250	1293.65
3"	11.50"	5.30"	2.87"	3.83"	3.57"	4.68"	B45BY-R300	2110.90

Kits for Ball Check Valves

Repair Kits

repair kit contains:

- (1) PTFE ball
- (1) EPDM/CF8M seat
- (1) EPDM cap gasket

Size	Part #	Price/E
1½"	B45BY-RK150	\$119.70
2"	B45BY-RK200	156.95
2½"	B45BY-RK250	324.40
3"	B45BY-RK300	664.55

Seal Kits

seal kit contains:

- (1) EPDM/CF8M seat
- (1) EPDM cap gasket

Size	Part #	Price/E
1½"	B45BY-SK150	\$46.75
2"	B45BY-SK200	55.75
2½"	B45BY-SK250	74.40
3"	B45BY-SK300	104.00

All FKM Seal Kits

FKM seal kit contains:

- (1) FKM/CF8M seat
- (1) FKM cap gasket

Size	Part #	Price/E
1½"	B45BY-SKV150	\$98.05
2"	B45BY-SKV200	122.15
2½"	B45BY-SKV250	158.10
3"	B45BY-SKV300	228.90

Replacement Balls

(1) PTFE Ball

Size	Part #	Price/E
1½"	B45BY-TB150	\$107.65
2"	B45BY-TB200	160.45
2½"	B45BY-TB250	369.60
3"	B45BY-TB300	794.70