

Butterfly Valves

Clamp Butterfly Valves

Features:

- minimal line pressure: 0.4 inches Hg vacuum @ 68°F
- temperature range: **15°F - 200°F**
- PTFE valve disc bushings decrease friction and increase cycle life
- valve is only 1-3/8" wide on all sizes and uses only 3/4" of the space
- 3 position reversible handle
- the grooved clamp housing connects directly to the corresponding sanitary clamp size
- easy assembly requires a hex key for the handle and wing nuts to secure and seal the housing onto lines
- can be modified for lockout/tagout
- actuation available: double acting, spring return and electric, call Dixon Sanitary at 800.789.1718 for details

Information supplied based on water media @ 68°F

Size	Break Torque (in-lbs.)	Assembly Torque (in-lbs.)	Pressure Rating (PSI)	Flow Coefficient (C _v)	Weight w/standard handle (lbs.)
1"	125	36	140	23	1.5
1½"	185	36	140	80	2
2"	200	21.6	120	230	2.5
2½"	260	21.6	120	264	3
3"	350	28.8	100	372	4
4"	495	43.2	70	800	6

Size	316L Stainless Steel with Silicone Seats		316L Stainless Steel with FKM Seats		316L Stainless Steel with EPDM Seats	
	Part #	Price/E	Part #	Price/E	Part #	Price/E
1"	B5102S100-A	\$197.90	B5102V100-A	\$244.55	B5102E100-A	\$197.90
1½"	B5102S150-A	197.90	B5102V150-A	242.30	B5102E150-A	197.90
2"	B5102S200-A	240.80	B5102V200-A	295.90	B5102E200-A	240.80
2½"	B5102S250-A	310.90	B5102V250-A	379.50	B5102E250-A	310.90
3"	B5102S300-A	367.80	B5102V300-A	444.30	B5102E300-A	367.80
4"	B5102S400-A	537.60	B5102V400-A	644.95	B5102E400-A	537.60



Size	Dimensions						Break Torque (inch lbs.)	PSI @ 68°F
	A	B	C	D	E	F		
1"	5.6"	2.8"	1.3"	1.3"	3.6"	5.6"	125	140
1½"	5.6"	2.8"	1.3"	1.3"	3.6"	5.6"	185	140
2"	5.6"	3.0"	1.3"	1.3"	4.1"	6.1"	200	120
2½"	5.6"	3.3"	1.3"	1.3"	4.6"	6.6"	260	120
3"	5.6"	3.6"	1.3"	1.3"	5.3"	7.1"	350	100
4"	5.6"	4.1"	1.3"	1.3"	6.4"	8.2"	495	70

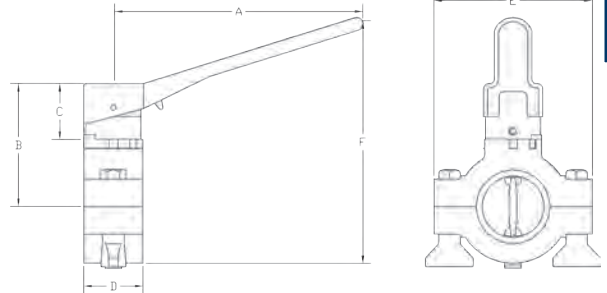

Repair Kit for Clamp Butterfly Valves

Repair kit contains:

- (1) seat
- (2) bushings

Valve Size	Black EPDM		Red Silicone		Brown FKM	
	Part #	Price/E	Part #	Price/E	Part #	Price/E
1"	B5102-RKE100	\$22.40	B5102-RKS100	\$28.45	B5102-RKV100	\$95.80
1½"	B5102-RKE150	16.25	B5102-RKS150	22.10	B5102-RKV150	86.00
2"	B5102-RKE200	23.90	B5102-RKS200	30.35	B5102-RKV200	109.20
2½"	B5102-RKE250	30.75	B5102-RKS250	36.15	B5102-RKV250	132.45
3"	B5102-RKE300	70.20	B5102-RKS300	81.10	B5102-RKV300	195.80
4"	B5102-RKE400	93.90	B5102-RKS400	101.65	B5102-RKV400	257.80