

DATE  
Sept. 12, 2005  
CAT. #: HH1002-50

OUTLINE DIMENSIONS  
3-PHASE INDUCTION MOTOR

MOTOR TYPE:  
AEHH  
FRAME NO. 405TS

Pole	HP	kW	Hz	VOLT	Syn. Speed r/min(rpm)
2	100	75	50	380	3000

Ins	Rating	Dimension in	Approx Weight	Bearings
F	CONT.	inches	1144 lbs.	DE: 6313C3 NDE: 6313ZC35C

Totally Enclosed Fan Cooled Type, Squirrel-cage Rotor.

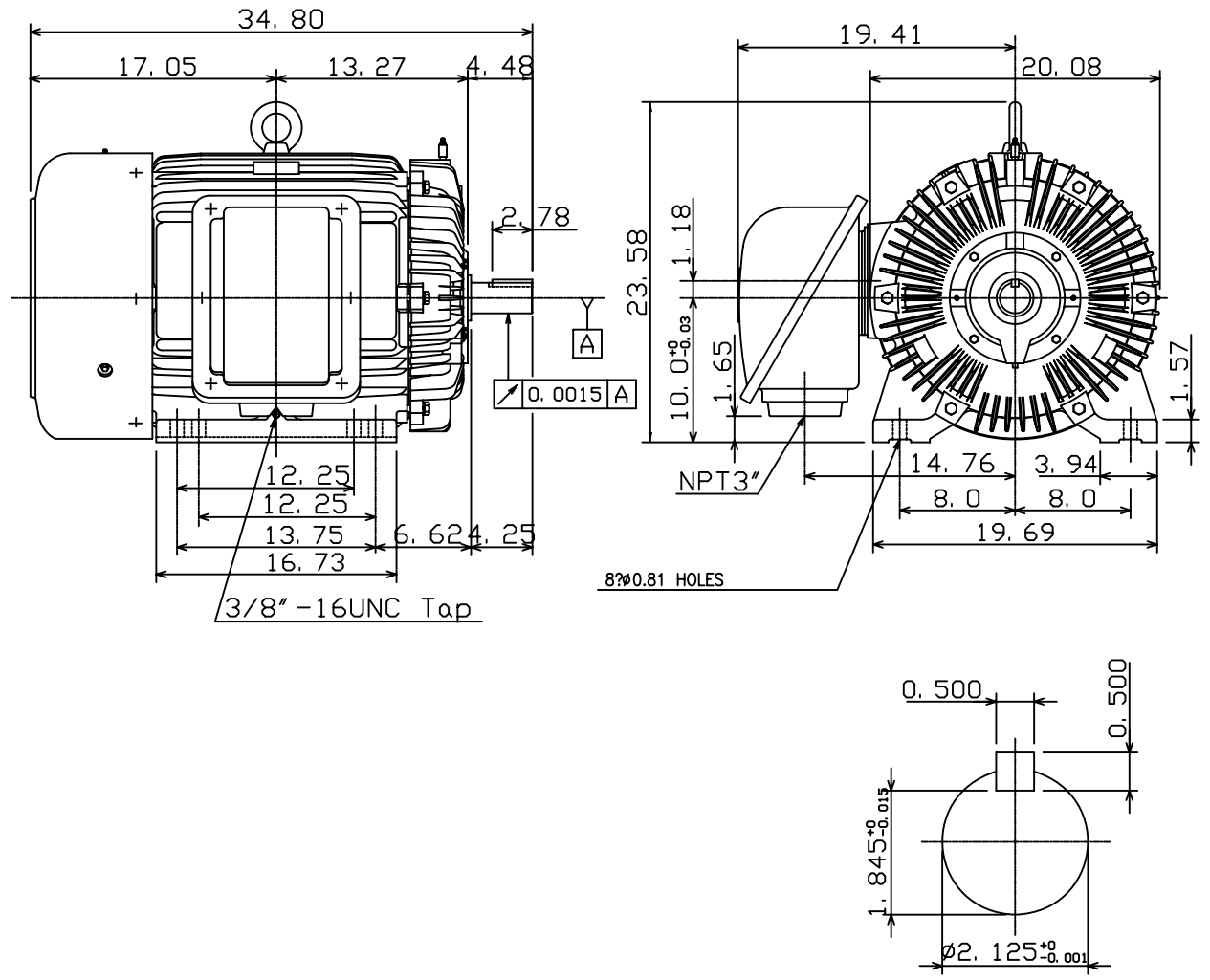

◇		
---	--	--

DWN. K. L. KUD 01-18-05  
CHKD. C. H. KAD 02-02-05  
APPD. M. C. TSAI 02-02-05



DWG NO. 31049M634570