

Straub Open-Flex 1L Couplings

Applications:

- Straub Open-Flex 1L couplings are suitable for repairing or joining pipes where access to the pipe end is difficult or impossible. This unique wrap-around design differs from similar type repair products because the installation or repair is permanent due to the unique flexible lip seal design. Open-Flex couplings will also act as an expansion joint. *Straub Open-Flex couplings do require the pipes to be properly anchored and restrained as they are not pull-out resistant like the Straub Grip-L couplings.* Use Straub Open-Flex couplings to replace bolted sleeve type couplings (AWWA Std. C-219) or for permanent repairs or installation.

Features:

- Joins like or dissimilar pipe materials: steel, galvanized, painted, stainless steel, thin-wall stainless steel, PVC, copper
- Requires no special tools or pipe-end preparation; only a torque wrench is required for a secure and safe pipe connection that seldom needs retightening.
- highest quality 316 Ti stainless steel construction
- accommodates up to 5° of pipe misalignment
- vary gap between pipe ends
- absorbs vibration, water hammer, and sound
- acts as an expansion joint; will accept up to .25" of axial movement
- 5 year limited warranty
- reusable

- conforms to ASTM 1476, Type 2, Class 3 specifications
- casing: AISI 316Ti
- screws: AISI 4135 steel
- bolts: AISI 12L 14 Galvanized
- EPDM sealing sleeve: temperature range - 4°F to 176°F (-20°F to 212°F)

Specifications:

- American Bureau of Shipping (ABS) up to 232 PSI
- Underwriter's Laboratories (UL)
- National Sanitation Foundation (NSF)

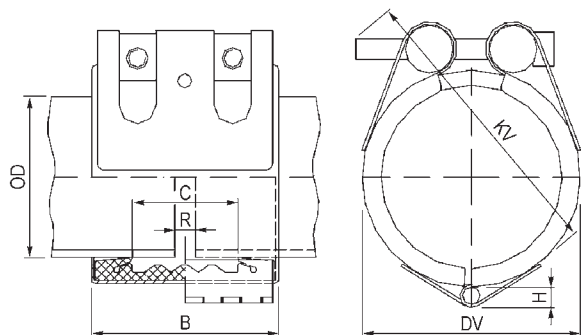

Size	Pipe OD		Working Pressure PSI	Coupling Dimensions			Assembled Dimensions		Max. Distance Between Pipe End R	Weight (lbs.)	Stainless Steel	
	actual	range min to max		B	C	H	DV	KV			Part #	Price/E
1½"	1.90"	1.85" to 1.95"	363	3.0"	1.4"	.28	2.8"	3.3"	.20"	1.10	STR35001	\$268.95
2"	2.38"	2.32" to 2.42"	232	3.0"	1.4"	.28	3.2"	3.7"	.20"	1.34	STR35151	284.95
2½"	2.88"	2.81" to 2.93"	232	3.0"	1.4"	.36	3.2"	3.7"	.20"	1.80	STR35201	310.00
3"	3.50"	3.44" to 3.56"	232	3.7"	2.0"	.36	4.4"	4.9"	.20"	2.10	STR35351	324.95
4"	4.50"	4.43" to 4.57"	232	3.7"	2.0"	.36	5.4"	5.9"	.20"	2.33	STR35651	343.65
5"	5.56"	5.49" to 5.57"	232	4.2"	2.4"	.38	6.4"	7.1"	.20"	3.20	STR35901	433.80
6"	6.63"	6.54" to 6.71"	232	4.2"	2.4"	.38	7.5"	8.1"	.20"	3.70	STR36051	464.80



Not pull-out resistant.

Ensure that pipes are properly anchored and supported.

Assembly tool: **STR6648**, \$348.55

