

Chains & sprockets	Wear strips	Side guide brackets & accessories	Levelers
Modular belts & sprockets	Chain & belt return systems	Frame & structure supports	Bearings
Curves & tracks	Side guide solutions	Miscellaneous products	Related information

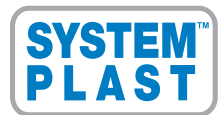

5 3 5 8 5 a

Mounting top

www.SystemPlastSmartGuide.com



Click here for related information.

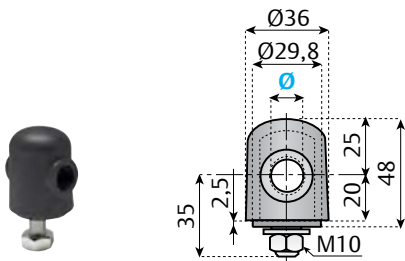

Material: reinforced polyamide; eyebolt, nut and washer in stainless steel AISI 304.

Ø 12	Ø 14	Ø 16	n° 50
Item description			
TOP-20P-P12B	TOP-20P-P14B	TOP-20P-P16B	

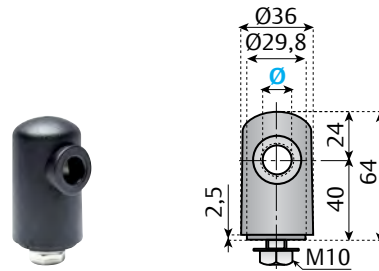

Material: head in reinforced polyamide, insert in nickel plated brass, screw and washer in stainless steel AISI 304.

Ø 12	n° 50
Item description	
TOP-40P-P12BB	

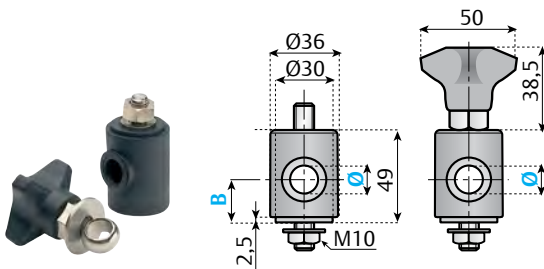

Material: reinforced polyamide, eyebolt, screw, nut, washer in stainless steel AISI 304, nut and hexagonal bushing in nickel plated brass.

Ø	B	Version without knob	Version with knob	n° 50
		Item description		
12	23	TOP-23P-P12T	TOP-23P-P12K	
14		TOP-23P-P14T	TOP-23P-P14K	
16		TOP-23P-P16T	TOP-23P-P16K	
20	24	TOP-24P-P20T	TOP-24P-P20K	

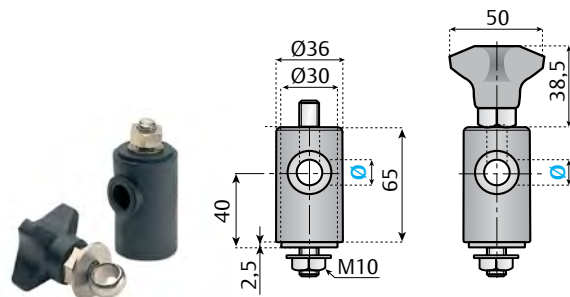

Ø	Version without knob	Version with knob	n° 50
12	TOP-40P-P12T	TOP-40P-P12K	
14	TOP-40P-P14T	TOP-40P-P14K	
16	TOP-40P-P16T	TOP-40P-P16K	

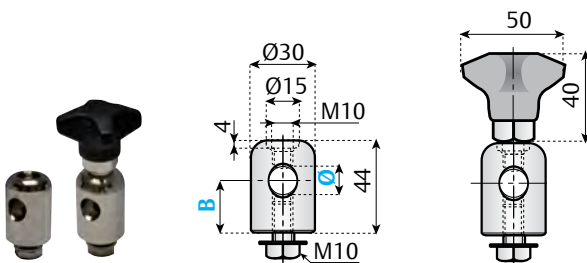

Material: screws and heads in stainless steel AISI 304.

Ø	B	Version without knob	Version with knob	n° 50
		Item description		
12	25	TOP-25S-P12T	TOP-25S-P12K	
14	24	TOP-24S-P14T	TOP-24S-P14K	
16	23	TOP-23S-P16T	TOP-23S-P16K	

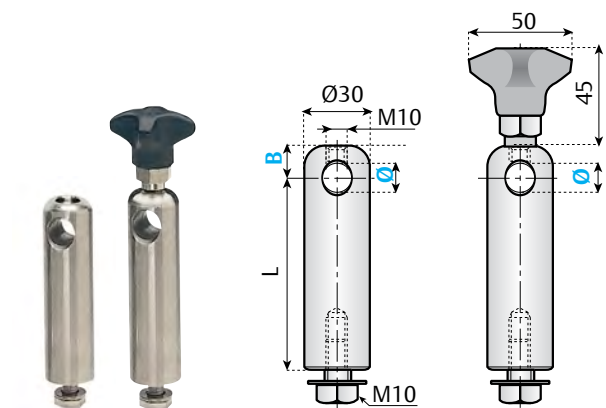

Material: screws and heads in stainless steel AISI 304.

Ø	L	B	Version without knob	Version with knob	n° 50
			Item description		
12	40	15	TOP-40S-P12T	TOP-40S-P12K	
	60		TOP-60S-P12T	TOP-60S-P12K	
	90		TOP-90S-P12T	TOP-90S-P12K	
14	60	16	TOP-60S-P14T	TOP-60S-P14K	
	90		TOP-90S-P14T	TOP-90S-P14K	
	40		TOP-40S-P16T	TOP-40S-P16K	
16	60	17	TOP-60S-P16T	TOP-60S-P16K	
	90		TOP-90S-P16T	TOP-90S-P16K	



For other type of mounting block, go to:

5 3 5 9 0 a