

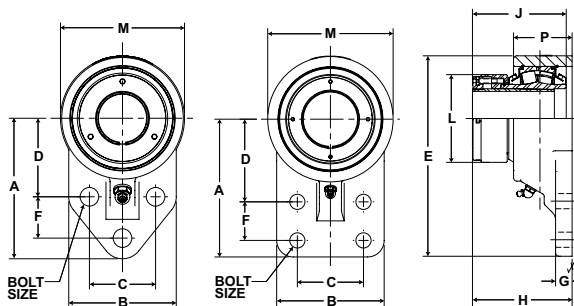

- Rolling Elements:** Spherical Roller
- Housing:** Ductile Iron Flange Bracket
- Self Alignment:** +/- 2 Degrees
- Lock:** Adapter
- Seal:** Felt
- Optional Seal:** Double Lip Contact
- Temperature:** -20° to 220° F



USBF5000A Series Three-Bolt Flange Brackets - Adapter Mount

Bore Diameter inch	Part No.	Basic Dynamic Rating lb/N	Dimensions inch / mm													Unit Wt. lb/kg
			A	B	C	D	E	F	G	H*	J	L	M	P	Bolt Size	
1 7/16	USBF5000A-107	20368	4 1/4	3 1/4	2	2 3/8	6 1/8	1 1/4	5/8	3 7/16	3 11/32	2 47/64	3 3/4	2 1/4	1/2	6.1
		90597	108.0	82.6	50.8	60.3	155.6	31.8	15.9	87.3	84.9	69.5	95.3	57.2		2.76
1 15/16	USBF5000A-115	23520	5 3/16	4	2 3/4	2 15/16	7 5/16	1 5/8	11/16	3 37/64	3 1/2	3 11/64	4 1/4	2 3/8	1/2	8.0
		105370	131.8	101.6	69.9	74.6	185.7	41.3	17.5	90.9	88.9	80.6	108.0	60.3		3.63

USBF5000A Series Four-Bolt Flange Brackets - Adapter Mount

Bore Diameter inch	Part No.	Basic Dynamic Rating lb/N	Dimensions inch / mm													Unit Wt. lb/kg
			A	B	C	D	E	F	G	H*	J	L	M	P	Bolt Size	
2 7/16	USBF5000A-207	44691	6 1/4	4 7/8	3	3 3/4	9 3/32	1 3/4	3/4	4 13/32	4 5/16	3 63/64	5 11/16	2 21/32	5/8	17.6
		198786	158.8	123.8	76.2	95.3	231.0	44.5	19.1	111.9	109.5	101.2	144.5	67.5		7.99

*For expansion bearings, this dimension can increase by the corresponding value in table VIII on page I-69.
 One expansion unit is to be used in conjunction with one non-expansion unit for applications using an adapter lock unit.
 Failure to utilize one expansion and one non-expansion unit is likely to result in reduced bearing performance.